

**NOTE:**

ALL LAND OTHER THAN THE PROPERTY UPON WHICH THE INDIVIDUAL UNITS ARE SITUATED, THE STORMWATER MANAGEMENT TRACTS AND THE LIFT STATION TRACT, SHALL BE CONSIDERED COMMON PROPERTY.

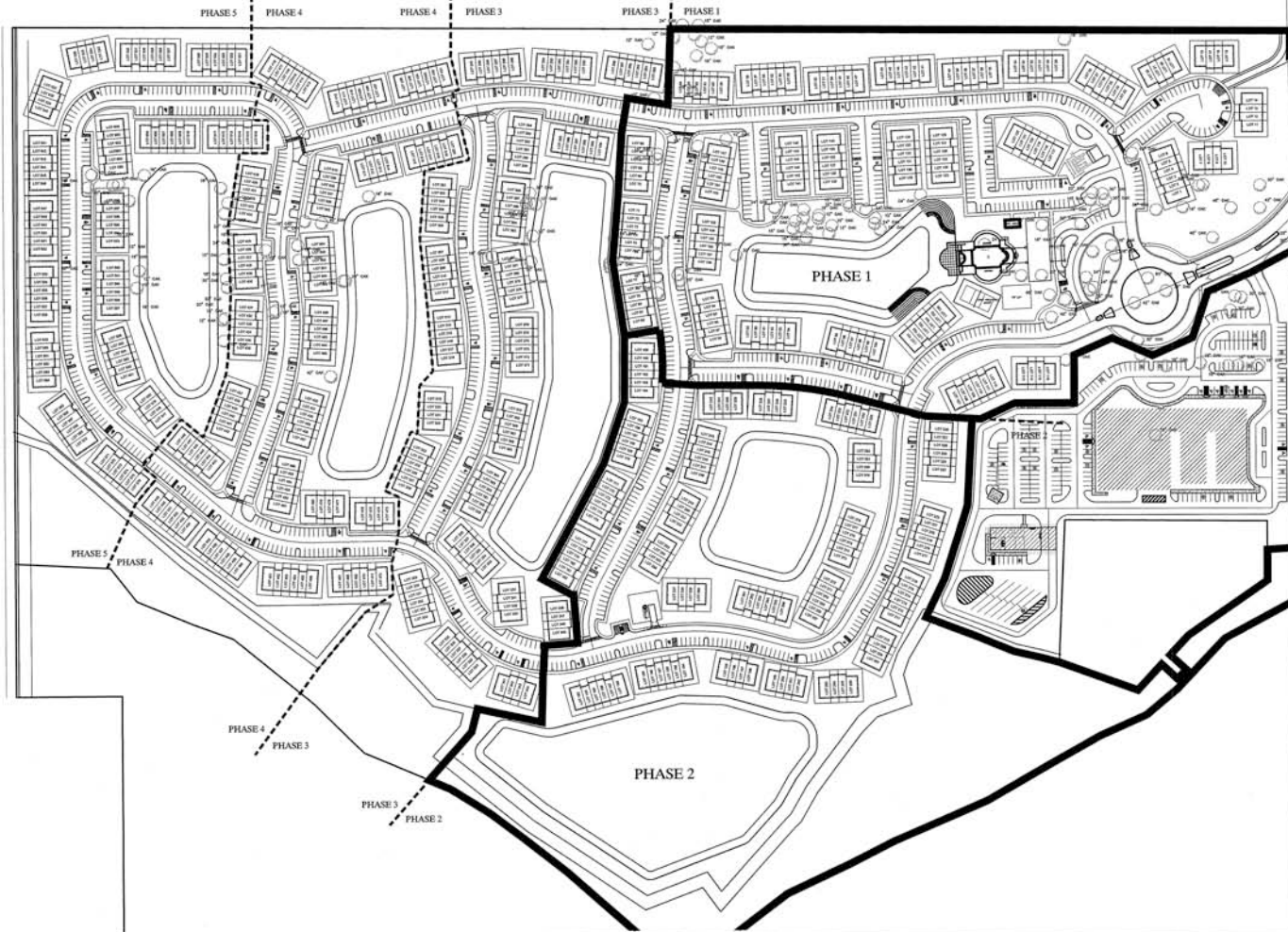

**SITE MODIFICATIONS**

- ADDITION OF TWO (2) VACUUM CAR WASH BAYS ADJACENT TO LIFT STATION.
- ADDITION OF COVERED DROP-OFF AREA FOR CLUBHOUSE.
- REMOVAL OF TWO (2) 30' OAKS, ONE (1) 30' OAK AND ONE (1) 30' OAK.
- MODIFICATION OF POND CONTOURS TO ACCOMMODATE POOL DECK OVERLOOK.
- MODIFICATION OF SIDEWALKS SOUTH AND EAST OF CLUBHOUSE.
- REMOVAL OF ONE (1) HANDICAP AND THREE (3) STANDARD PARKING STALLS AT CLUBHOUSE.
- REMOVAL OF TWO (2) STANDARD PARKING STALLS AND THE ADDITION OF ONE (1) HANDICAP PARKING STALL NORTH OF THE CLUBHOUSE.

<b>REVISED PARKING TOTALS</b>	
TOWNHOME PARKING REQUIRED	1,231 SPACES
HANDICAP PARKING REQUIRED (1 PER 100 OVER 300 SPACES)	30 SPACES
TOTAL PARKING REQUIRED	1,266 SPACES
TOWNHOME PARKING PROVIDED	1,232 SPACES
HANDICAP SPACES	332 SPACES
TOTAL PARKING PROVIDED:	1,564 SPACES

**RD DEVELOPMENT GROUP INC.**  
*conceptualize a reality*  
 Cert. of Authorization Number: 000028066  
 P.O. Box 701509, St. Cloud, FL 34770-1509  
 email: mail@rdgi.com

address:  
 Real Deal Development Group Inc.  
 Post Office Box 701509  
 St. Cloud FL 34770-1509  
 Phone: (407) 957-0019  
 Fax: (407) 892-0697  
 E-mail: mail@rdgi.com

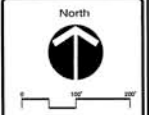

Scale: 1" = 100'  
 Date: September 19, 2005

location:  
 Osceola County, Florida  
 Sec 26, Twn 25 S, R 29 E

project:  
**Heritage Key Villas**

client:  
**FLPRD, LLC**

drawing file

**Master Site Plan**

sheet number:  
**1 of 1**

THIS DOCUMENT IS THE PROPERTY OF REAL DEAL DEVELOPMENT GROUP INC. AND IS TO BE USED ONLY FOR THE PROJECT AND PHASE SPECIFICALLY IDENTIFIED HEREIN. ANY REUSE OR REPRODUCTION OF THIS DOCUMENT WITHOUT THE WRITTEN PERMISSION OF REAL DEAL DEVELOPMENT GROUP INC. IS STRICTLY PROHIBITED.